

Project · Reference number

Date

**Application**

LED-Pole top luminaire with asymmetrical flat beam light distribution.

The used LED technique offers durability and optimal light output with low power consumption at the same time.

For mounting heights 7000 - 9000 mm.

**Product description**

Luminaire made of aluminium alloy, aluminium and stainless steel

Safety glass

Silicone gasket

Reflector made of anodised pure aluminium

Toolless closure

Adjustable joint for beam direction 0° or 15°

For pole top ø 76 mm

Inner diameter of the pole min. 58 mm

Slip fitter insert depth null mm

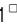
Connecting cable X05BQ-F 4x1 

Cable length 9 m

LED-Power supply unit



220-240 V ~ 50/60 Hz

Dimmable 1-10 V

**SELV (safety extra-low voltage)**

Luminaire: Protection class IP 66

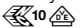
Protected against dust entry and water jets

Safety class II  – Safety mark**CE** – Conformity markWind catching area: 0.07 m<sup>2</sup>

Weight: 8.6 kg

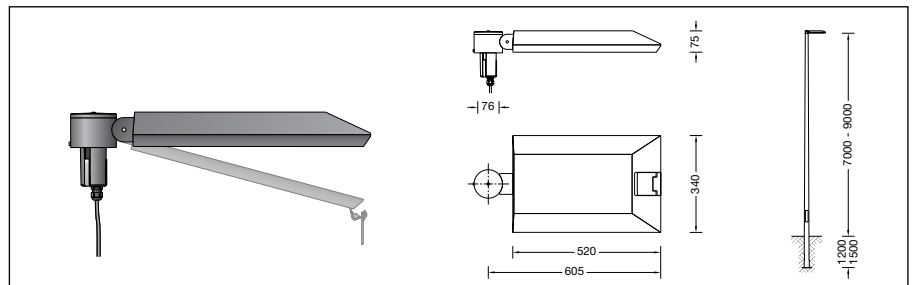
[www.bega.com](http://www.bega.com)**Lamp**

LED 4000 K

Connected wattage

Lamp luminous flux

Luminaire luminous flux

Colour rendering index

BEGA Article No.

101.2 W

115 W

11520 lm

7868 lm

 $R_a > 80$ 

4x LED-0282/840

LED 3000 K

Connected wattage

Lamp luminous flux

Luminaire luminous flux

Colour rendering index

BEGA Article No.

101.2 W

115 W

10740 lm

7335 lm

 $R_a > 80$ 

4x LED-0282/830

**Article No. 9596s**

Colour temperature 4000 K.

Also available with 3000 K on request.

4000 K – article number

3000 K – article number + **K3**Colour graphite or silver  
graphite – article number  
silver – article number + **A****Accessories**For this luminaire a comprehensive range of accessories is available - see BEGA web page [www.bega.com](http://www.bega.com).**Light distribution**